

Sarina Community Native Gardens

DEMONSTRATING THE USES & BENEFITS OF NATIVE PLANTS



THE GARDENS INCLUDE:

- A SHOWCASE OF NATIVE PLANTS IN GARDEN SITUATIONS
- SENSORY GARDENS (TASTE, SMELL, TOUCH, SIGHT & SOUND)
- REPRESENT LOCAL HABITATS INCLUDING COASTAL, WETLANDS, RIPARIAN &, RAINFOREST
- SEASONAL WETLAND & BOARDWALK
- WALKING TRACK



HISTORY

The Sarina Community Native Garden project was identified in 2008, by Sarina Landcare Catchment Management Association Inc. (SLCMA) and volunteers as a way to involve the community and provide an opportunity to raise awareness about the benefits of using native plants as an alternative to non-native &/or weedy species.

Permission to install the gardens on the 0.25ha site, was approved by Mackay Regional Council in 2009. After consultation and planning with Mackay Regional Botanic Gardens and Native Plants QLD - Mackay Branch; onground works began in late 2009. The gardens were officially opened in 2013, by Gardening Australia guru, Costa Geordiadis.

The gardens are managed by SLCMA with support from a variety of programs including the 'Friends of the Gardens' volunteer program.

Sarina Community Native Gardens, located next to the SLCMA Office on the corner of Sarina Beach & Cemetery Roads. For more information contact Sarina Landcare (SLCMA) on 4956 1388 or admin@sarinalandcare.org.au



Sarina Community Native Gardens

DEMONSTRATING THE USES & BENEFITS OF NATIVE PLANTS

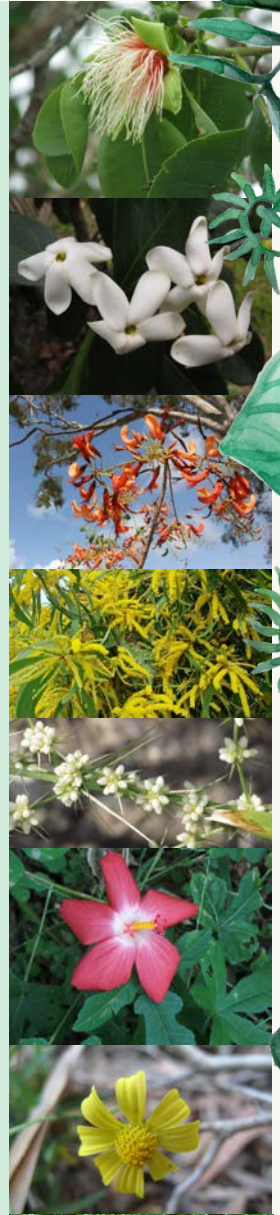
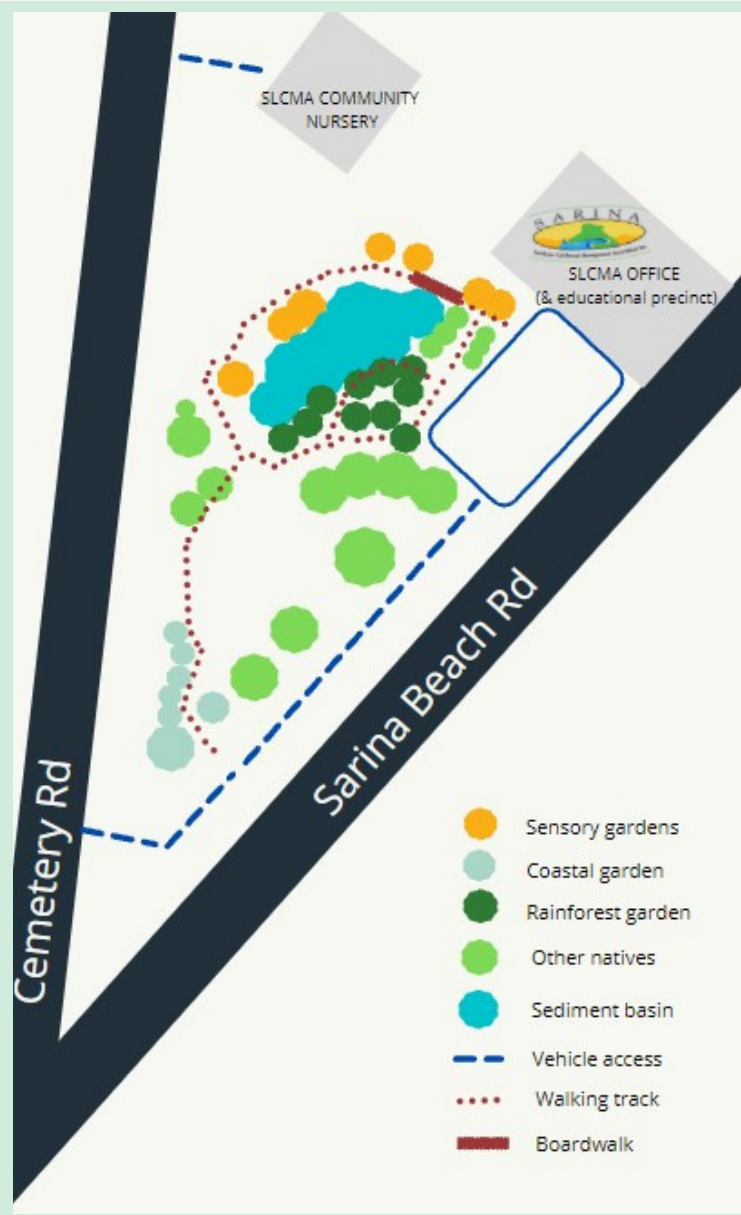

Proudly supported by:



From little things, big things grow!