

# SLCMA Catchment News 2024



## March

**Office:** 101 Sarina Beach Rd  
Sarina, QLD, 4737

**Phone:** (07) 4956 1388

**Website:**

[www.sarinalandcare.org.au](http://www.sarinalandcare.org.au)

**Email:**

admin@sarinalandcare.org.au

### Office hours:

Mon/Wed: 9am-4pm

Tue/Thu: 9am-2pm

Fri: 9am-3.30pm

*Please phone ahead to confirm availability, just in case we are out on a project or meeting.*

### Staff

#### Coordinator

Saskia von Fahland

#### Administration Officer

Helen Dangerfield

#### Project Officer

Rodney Fraser

#### Nursery Officer/ Field Supervisor

Susie Tomlinson

#### Field Team Leader

Helen Lynch

#### Field Team

Nate Farnham

Chantelle Woods

Dominique Jooste

#### Call us for information:

◇ Weed management

◇ Plant identification

◇ Land management

◇ Land for Wildlife

#### Volunteer opportunities:

SLCMA Community

Volunteer Program,

Wednesday, 9-12 noon.

**Native plants** available for

purchase \$3.30 each. Visit [website](http://www.sarinalandcare.org.au) for latest plant order form.

#### SLCMA Executive 23/24

**Chair:** Lachlan McBride

**Vice-chair:** vacant

**Treasurer:** Susan Andrews

**Secretary:**

Karen May

**Executive members:**

Kath De Vita



## SLCMA News!

A message from our new SLCMA Committee member:

Hi, I'm Kath De Vita and recently become a SCLMA committee member.

I am a HR professional with 20 years experience in various industries including as mining services, engineering legal, accounting and not for profit. I specialise in providing HR advisory services on recruitment and onboarding, performance and remuneration, recognition and benefits, talent management, succession planning, and employee engagement, policies and procedures, systems, statutory compliance requirements and payroll management.

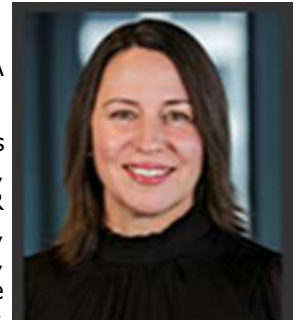

Welcome, Kath De Vita

I grew up in Central Queensland and come from a farming and cropping family background. I went to high school in Rockhampton but I am now based in Brisbane where I live with my husband, 2 daughters and a cocker spaniel dog. When I'm not working I enjoy a day out hiking, or at the beach.

We also have a new staff member for the Landcare Field Team...

Dominique has come to Sarina Landcare with 8 years' experience as a registered nurse, working primarily in the medical oncology and haematology sector. During this time, it became clear to her that nature played an integral role in the healing process, not only for the physical body, but the mental and spiritual body too. It is a hope of Dom to one day collaborate nursing and nature experiences to create a healing environment for those in need of it.

Dom has spent many hours hiking, exploring, and photographing Mackay and surrounds, and like many, have been captivated by the diverse native flora and fauna of this region. She has also been fortunate to have worked as an assistant gardener on a local permaculture property, where her interests in this field really started to grow. In Doms' spare time she can be found painting, playing piano or tending to her home garden.

"I feel so privileged to be working alongside a passionate team of experienced, kind, and knowledgeable people, and I am also very eager to learn as much as I can from this incredible community of like-minded people. Thank you, Sarina Landcare, for your warm welcome."



Welcome, Dominique Jooste!

## Reef Assist Program supports driver training

Our Field Team Leader, Helen, recently collaborated with fellow Reef Assist teams from the Whitsunday and Pioneer Catchment Landcare Groups to bolster their vehicle expertise and driving prowess. As part of the dynamic RAP employee development initiative, our dedicated staff immersed themselves in comprehensive 'Light Vehicle and 4x4 Driver Training'.

This immersive experience delved into crucial topics including fatigue management, vehicle dynamics, tire maintenance, recovery protocols, precise braking techniques, load securing methods, and the versatile capabilities of 4WD vehicles. Moreover, the training provided invaluable insights into navigating diverse terrains with confidence and skill.

This proactive approach not only enhances our team's proficiency but also underscores our unwavering commitment to safety, efficiency, and continuous improvement in our mission to protect and preserve our local environment.



SLCMA, WCL & PCL Reef Assist team members

## SLCMA 'Plant of the Month'

This month's 'Plant of the Month' is: **Native Ginger -red-backed (*Alpinia caerulea*)** Family: Zingiberaceae

**What is in a name?** The genus name *Alpinia* was coined by Carl Linnaeus in honour of the Italian botanist Prospero Alpini, and the species epithet *caerulea* is derived from the Latin word caeruleus, meaning blue, which is a reference to the fruit colour.

**Form:** Clumping thick, erect stems to 2m, rising from underground rhizome.

**Leaves:** Broad sword shaped green leaves with attractive red underside.

**Flower:** The inflorescence is terminal on the stalks, up to 30cm long and contains numerous white flowers.

**Fruit:** Blue, globose capsule, about 1cm in diameter. The casing is thin and brittle, and contains numerous black seeds set in white pith.

**Habitat:** Grows in coastal and sub-coastal rainforest, wet sclerophyll forest, commonly beside waterways. The altitudinal range is from sea level to around 1,400m.

**Distribution:** Queensland and Northern New South Wales — this particular variety comes from the Atherton Tablelands, near Cairns.

**Notes:** For the Kuku Yalanji people of far northern Queensland, this plant had many uses – the fruit and rhizomes were eaten, the leaves were used to cover their shelters and to wrap meat when cooking in earth ovens. New shoots are also edible, and have a mild ginger flavour. The white flesh surrounding the seeds is crisp and acidic, and during long walks it was chewed by Indigenous Australians to activate the salivary glands and moisten the mouth, with the seeds usually being discarded.

The "**Plant of the Month**" is currently available from the SLCMA Community Nursery. Landcare members are eligible to receive 1 free "Plant of the Month", throughout that month. This and other native plant species are also available for purchase at \$3.30 each. All plants are grown from locally sourced seed in the SLCMA Community Nursery by SLCMA staff and the SLCMA Volunteer team.

Information sourced from: [https://en.wikipedia.org/wiki/Alpinia\\_caerulea](https://en.wikipedia.org/wiki/Alpinia_caerulea),  
<https://gardeningwithangus.com.au/alpinia-caerulea-native-ginger/>



Photo: R Fraser

Leaves, showing red underside



Photo: S von Fahland

Fruit of native ginger

## Sarina Community Nursery Volunteer Program

Thank you to the wonderful volunteers that assist in the nursery whenever possible. It is always a pleasure to have their company and helping hands. No matter the task given, whether it is pot washing, weeding, cleaning/ sowing seed or potting on seedlings, they are always smiling.

A few of the volunteers joined the nursery officer Susie for an outing to Freshwater point recently on a plant identification and seed collecting trip. The group collected a bounty of seed for propagation in the nursery. Plants included *Glochidion lobocarpum*-Cheese tree, *Jagera psuedorhus*-Foambark and *Jasminum didymum*-Coastal jasmine, useful plants for revegetation projects and home gardens. Afterwards a well-earned morning tea was enjoyed at the Armstrong beach boat ramp park.

The last Wednesday of the month is a designated seed collection and plant identification field trip. Volunteers will be notified via email regarding the location, meeting place and other details.

**If you would like to volunteer in your local community and meet new people while learning about local native plants and their propagation, come along to the SLCMA Community Volunteer morning, every Wednesday, 9am to 12noon.** For more details contact SLCMA on 4956 1388. The SLCMA Community Volunteer Program is proudly supported by Mackay Regional Council, Natural Environment Levy.



Photos: S Tomlinson

# My Pest Guide Reporter– Identification App



**Help monitor, manage and keep exotic pests out of Australia.**

MyPestGuide® brings communities together in order to create a collaborative network of people to report, map and learn about pests and other organisms. MyPestGuide Reporter is the App that lets everyone report all kinds of plant pests, diseases, animals and aquatic organisms, they also do weeds...



For weeds select the drop down menu in "Send report to" and select "MyWeedWatcher" or for other pests, select "MyPestGuide".

MyPestGuide was developed to encourage everyone (public, industry and government) to report observations of any common, interesting or possibly exotic pests, as well as the absence of pests across Australia. Your reports are received by experts at the Department of Agriculture and Food, Western Australia (DAFWA) who identify the pest, reply back to your device and map it online so everyone can learn about pest problems.

By using the MyPestGuide Reporter App you are supporting your local community, defending Australia's agriculture industry and protecting the natural environment from exotic pests.

A knowledgeable community can get on top of pest problems quickly! So, help reduce the costs of eradicating and managing pests long-term. Join up and be a part of the reporting community.

The MyPestGuide® on-line community web page is where the shared reports are mapped and made available for the community to view and learn more about what pests and other organisms are reported near you.

MyPestGuide welcomes all comments and suggestions from the user community and gratefully acknowledge the input received from everyone to date. Feel free to email them at [mypestguide@dpird.wa.gov.au](mailto:mypestguide@dpird.wa.gov.au) or send them a report with your comments included in the text boxes.

## Sarina Community Native Gardens

The gardens are booming with lushness from the abundant rain this wet season. The plants all look so healthy and happy! It's wonderful to witness the gardens growth during this boom time. Its also a time of head down bum up, pulling weeds, mulching, clipping and shaping, in an effort to control this booming growth. But, if you're a gardener, this is what you do and you do it for the journey and the outcome. Connecting with nature, creating, relaxing, your happy place.

The gardens are always open to the community and many of the plants are labelled to assist with identification. Visitors are welcome to walk around the gardens on a self-guided tour or if you would like to organise a group guided walk, contact us 4956 1388 or [admin@sarinalandcare.org.au](mailto:admin@sarinalandcare.org.au)

Above: Walking track through the gardens; L-R: Bower of Beauty (*Pandorea jasminoides*), Velvet Leaf (*Callicarpa pedunculata*)



### 1. Open the app on your mobile device



### 2. Create a report



### 3. Take a photo

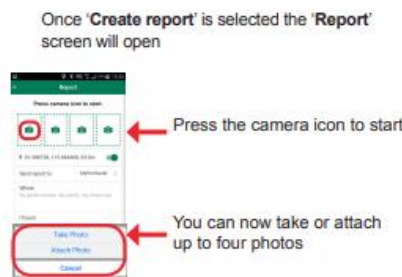

### 4. Location for Google maps viewing



### 5. Enter details about your observation

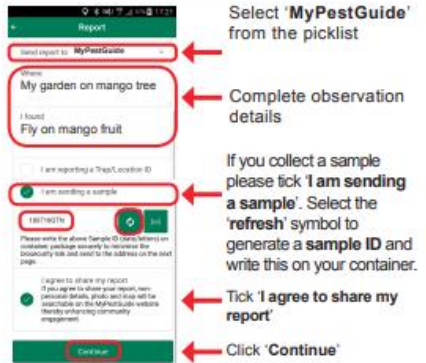

### 6. Confirm your contact details

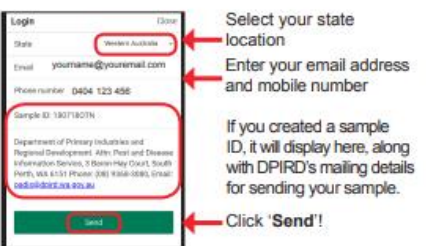

Any reports you make using the app will be stored within the app for reference, along with our response.

For more information visit [mypestguide.agric.wa.gov.au](http://mypestguide.agric.wa.gov.au)



**Address:** 101 Sarina Beach Rd, Sarina QLD 4737  
**Phone:** (07) 4956 1388  
**Website:** [www.sarinalandcare.org.au](http://www.sarinalandcare.org.au)  
**Email:** [admin@sarinalandcare.org.au](mailto:admin@sarinalandcare.org.au)

## What SLCMA Membership does for you !

A membership with SLCMA has many rewards:

- ◇ Easy access to Natural Resource Management information and extension
- ◇ Monthly newsletter, meeting minutes, progress and project reports
- ◇ A vote on issues in your catchment
- ◇ A say in the types of projects applied for
- ◇ Up to 10 free local native seedlings/year from the SLCMA Community Nursery
- ◇ Invitations to Natural Resource Management field days and workshops
- ◇ Copy of the SLCMA Annual Report

Monthly rainfall for SLCMA Office, 2006 -2024 (inc annual total)

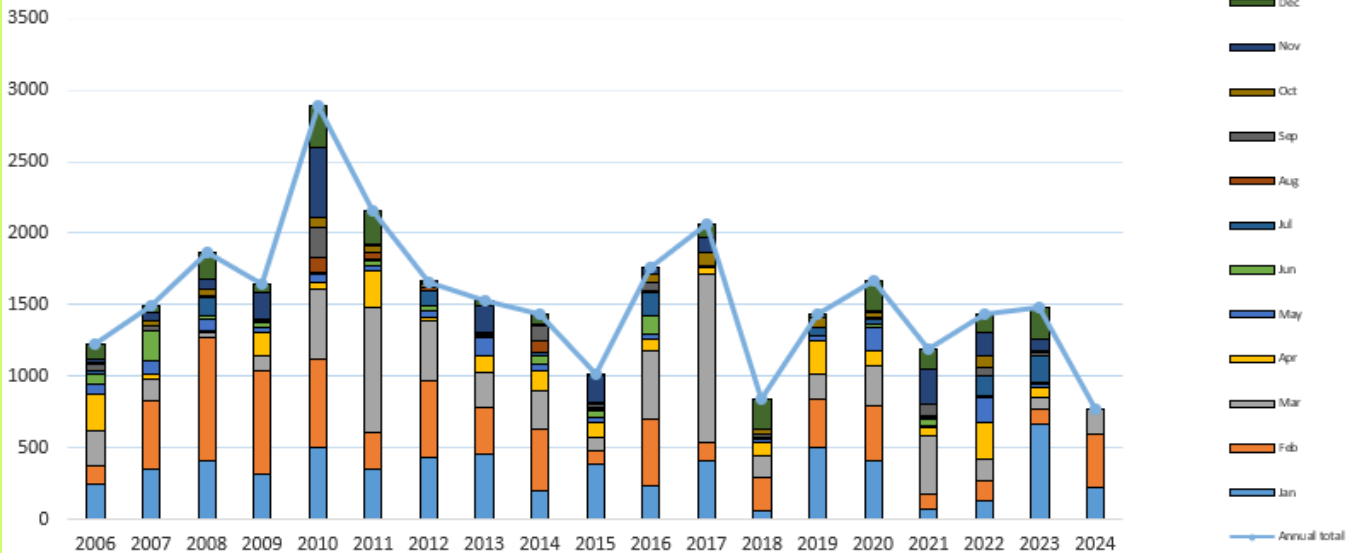

Please consider donating your Containers for Change to SLCMA. It is a great way to help the environment and the community. You can reduce waste, save energy, and contribute to local environment projects and programs.



SLCMA's Scheme ID  
**C10002138**

**A partnership for the natural resource management of catchments in the Central Queensland Coast Bioregion: Pioneer, Sarina & Whitsunday Catchments.**

## Just for fun!



How do you properly identify a dogwood tree?  
*By its bark.*

What type of tree can you hold in your hand?  
*A palm tree.*

What did the flower say to the flower beside him?  
*Move over bud.*

"The swordfish has no natural predators to fear from. Except the penfish, which is supposed to be even mightier."



**Find us on facebook**



**SLCMA is proudly supported by:**

